

PROPOSED DEVELOPMENT (1:750)

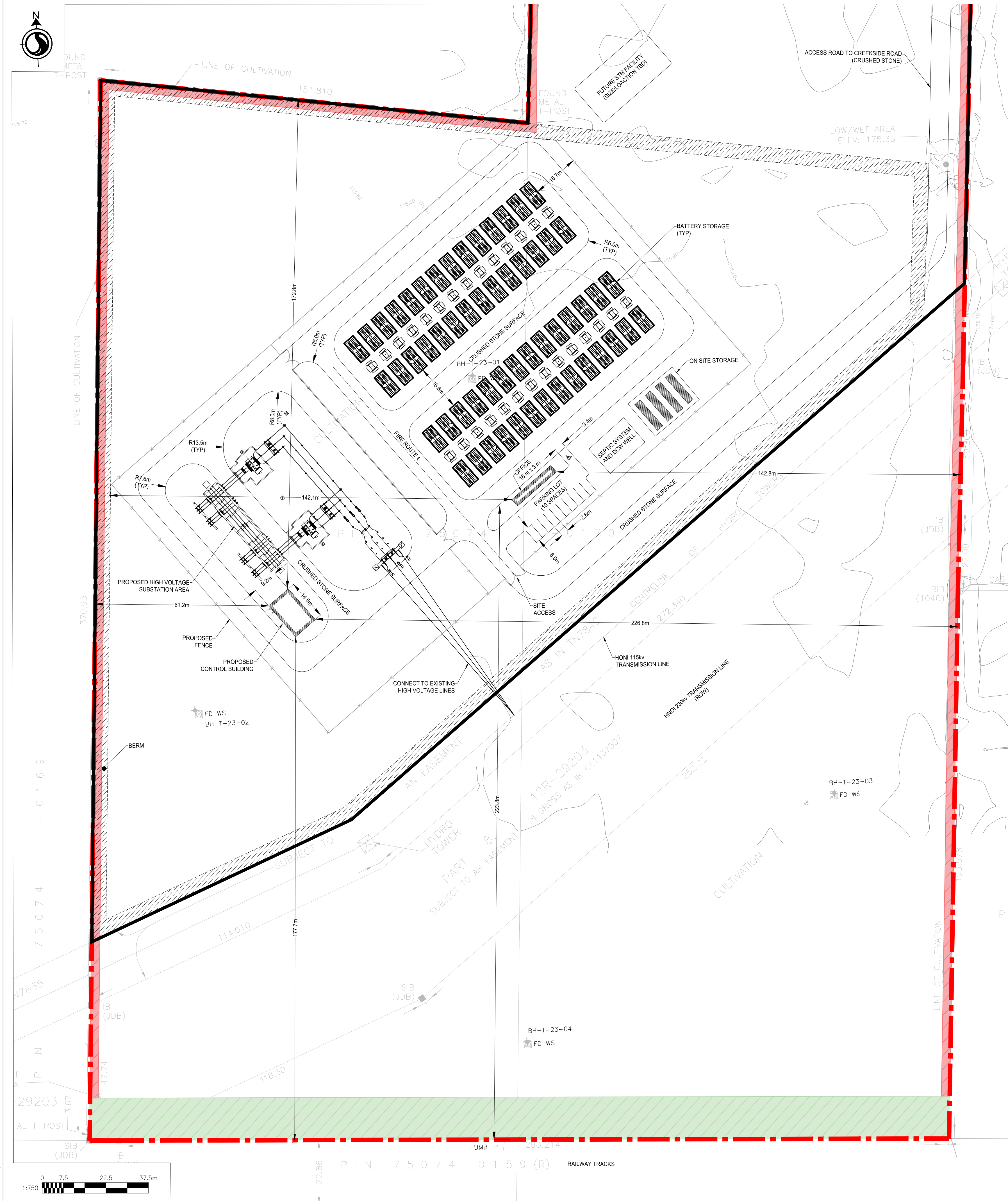

SUBJECT PROPERTY (1:5000)

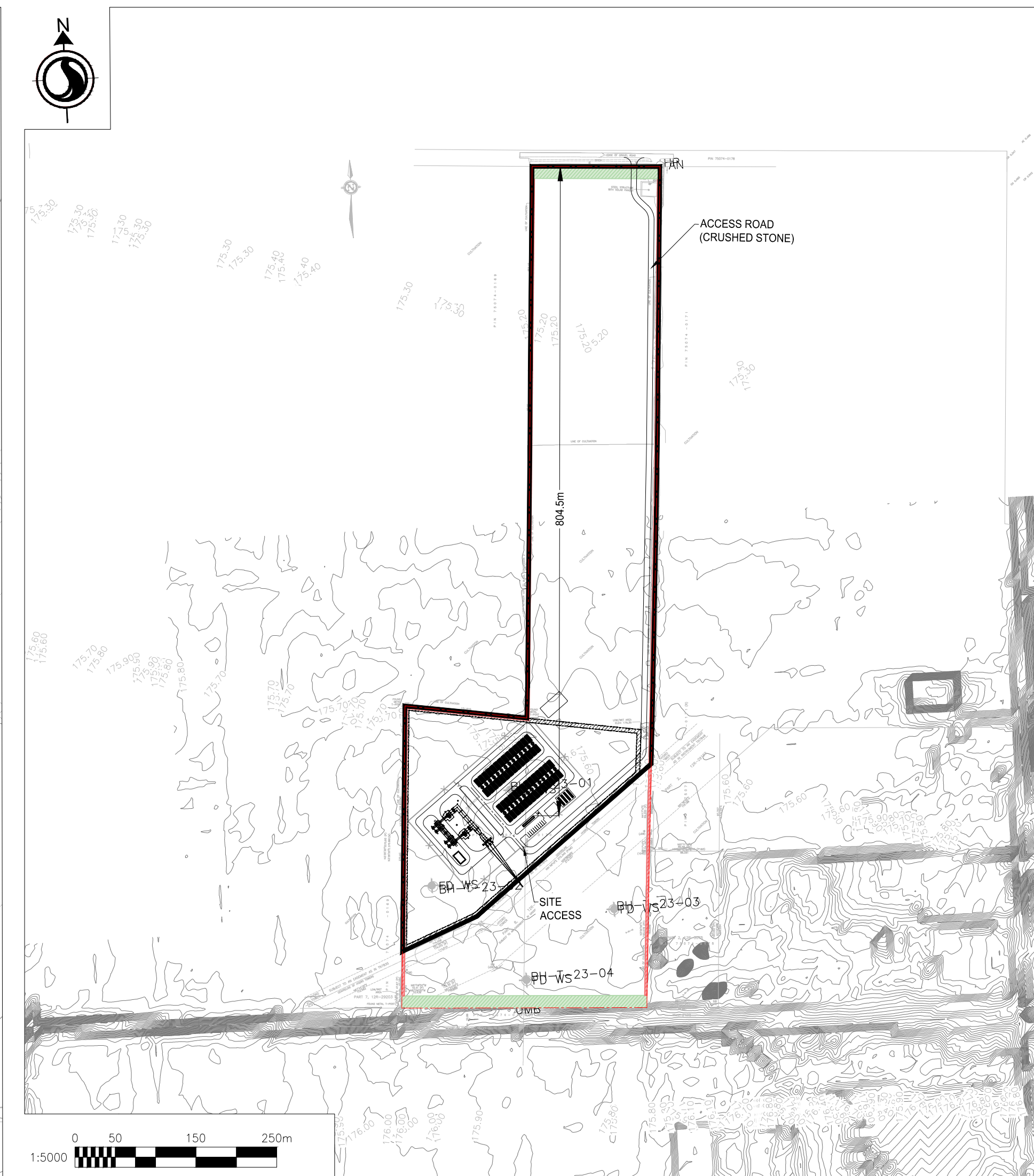

SITE ENTRANCE (1:500)

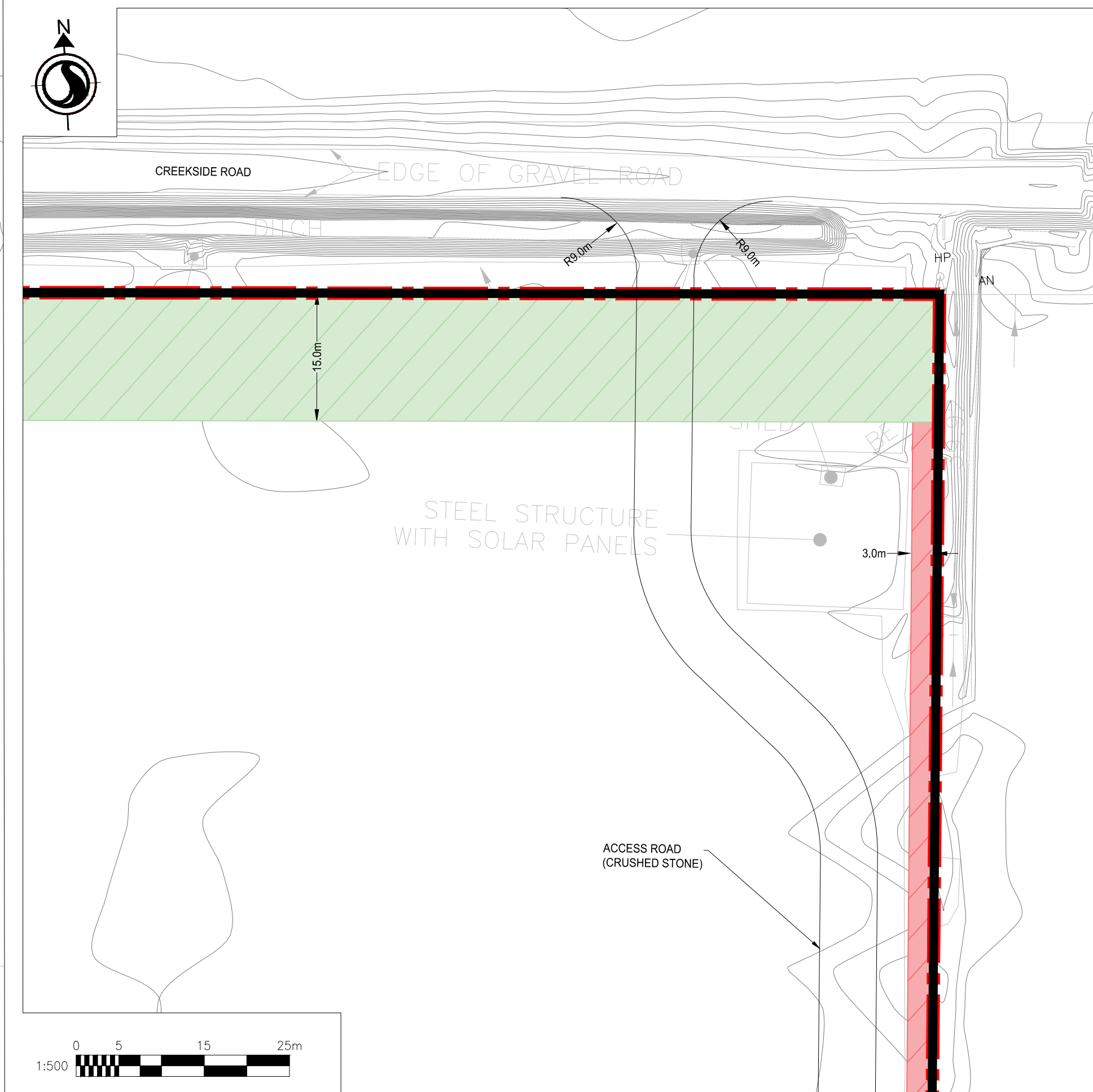

Stantec Consulting Ltd.  
100-300 Hagey Boulevard  
Waterloo ON N2L 0A4  
Tel: (519) 579-4410  
www.stantec.com

Copyright Reserved  
The Contractor shall verify and be responsible for all dimensions. DO NOT scale the drawing  
- any errors or omissions shall be reported to Stantec without delay.  
The Copyrights to all designs and drawings are the property of Stantec. Reproduction or  
use for any purpose other than that authorized by Stantec is forbidden.

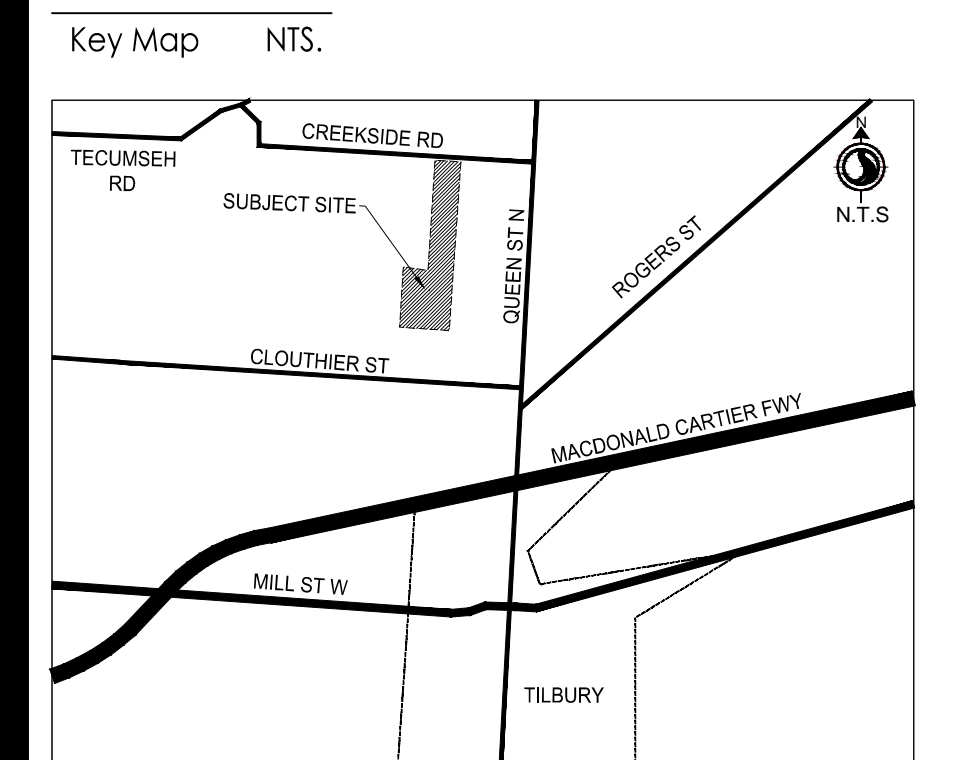

Legal Description  
Part of Lot ---, Block ---,  
Registered Plan ---,  
City of ---,  
Region of ---

Details of Development

SITE DETAILS	REQUIRED	PROVIDED
ZONING	8.9 Agriculture Zone Regulation "Agricultural Uses and Accessory Uses"	
SETBACKS		
FY	15.0 m	805 m
RY	15.0 m	178 m
EXT. SY	6.0 m	N/A
INT. SY	3.0 m	143[E]/61[W]
MINIMUM LOT AREA	19.0 ha	21.8 ha
MAXIMUM LOT AREA	N/A	21.8 ha
MINIMUM LOT FRONTAGE	75.0 m	158 m
MINIMUM LANDSCAPED / OS	N/A	N/A
MAXIMUM HEIGHT OF BUILDINGS AND STRUCTURES	10.5 m	10.5
PARKING	N/A	10
BARRIER FREE PARKING	1	1

- LEGEND
- SITE BOUNDARY
  - LIMIT OF PROPOSED DEVELOPMENT
  - BERM
  - PROPOSED FENCE
  - ZONING BYLAW PROPERTY LINE SETBACK (FY/RY) - 15 m
  - ZONING BYLAW PROPERTY LINE SETBACK (INT. SY) - 3.0 m

ISSUED FOR	CO	DATE
ISSUED FOR ZBA	CO	2024.01.15
DRAFT - CLIENT REVIEW	TR	2024.01.04

Permit-Seal

PRELIMINARY  
FOR DISCUSSION PURPOSES ONLY

Client/Project  
TILBURY BATTERY STORAGE Inc.

ZONING AMENDMENT  
0 Creekside Road, Tilbury ON

Title  
MUNICIPALITY OF LAKESHORE  
ZONING AMENDMENT  
SITE PLAN

Project No. 160623212 Scale

Revision Sheet Drawing No.  
0 1 of 1 SP 1

C:\Users\j\OneDrive\Documents\160623212\160623212\_01.dwg 1/15/2024 10:58 AM By: [Name] ORIGINAL SHEET - ARCH D