

No. 284

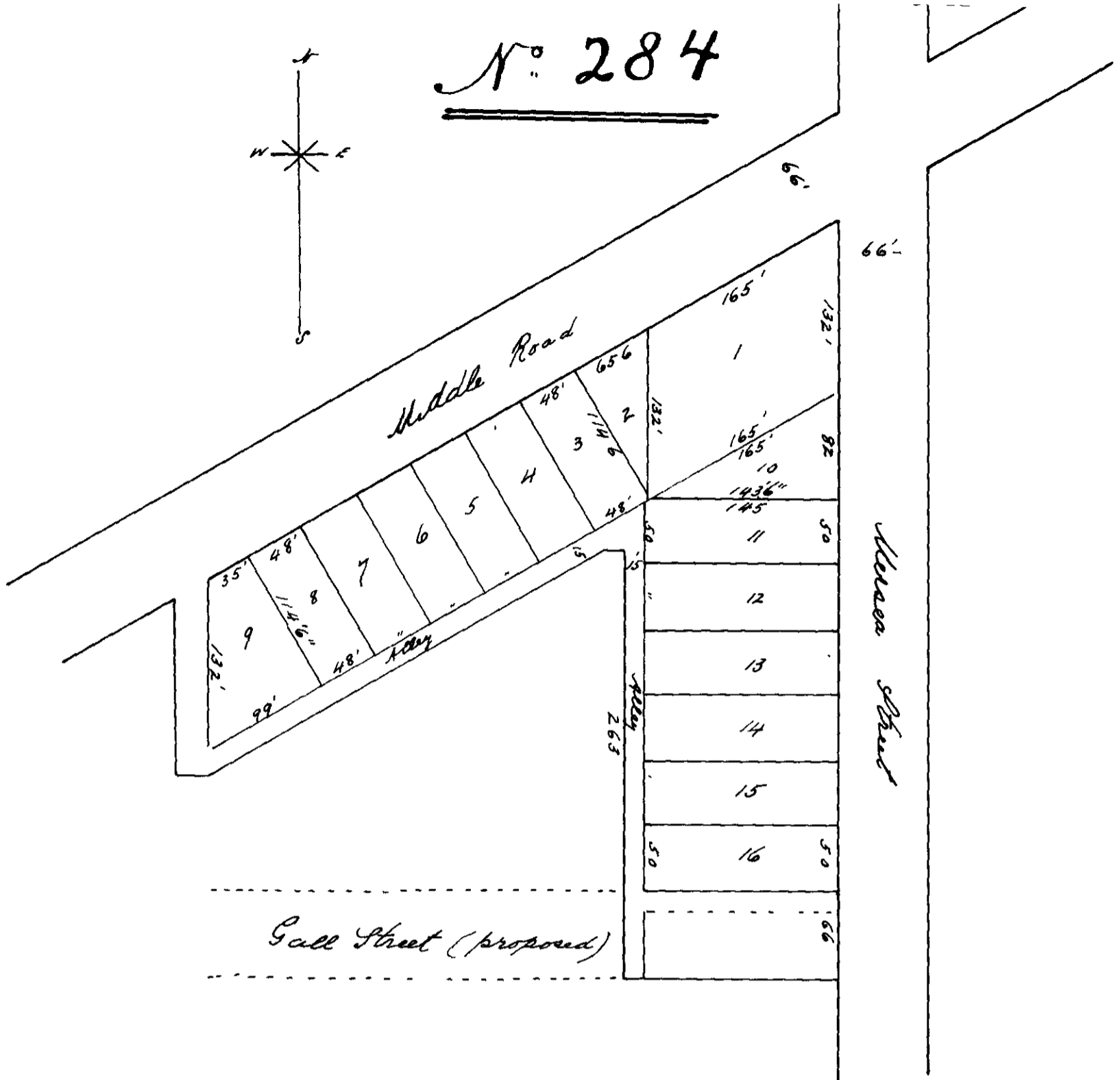

Part of the Village of Comber showing Village
lots laid out on lot No 6 South of the Middle Road,
Township of Tebury, West
Scale 100 feet to One Inch

This Plan is Correct and is prepared under the Provisions
of the "Registry Act" on
20th April 1883

A. Williamson
P.S.

This is a Plan of my Property and shows a
subdivision made in accordance with my
instructions
20th April 1883
Alfred Cameron

30th Entered and Registered
this 9th day of December
A.D. 1885 at 3 O'Clock
and 15 minutes of pm.
M. J. Macdonald
Registrar

CERTIFIED TO BE A TRUE COPY OF PLAN
REGISTERED IN THE REGISTRY OFFICE FOR THE
REGISTRY DIVISION OF _____

This is to certify that this is a true copy of Registered Plan
No 284 in the Registry Office of the County of Essex
Windsor, Ontario - 30th Dec 1926
C. W. Campbell
Ontario Land Surveyor

DATE _____ REGISTRAR _____